

GARDEN APARTMENTS: THE ORCHID

TWO-BEDROOM GRAND / 1,037 SQUARE FEET

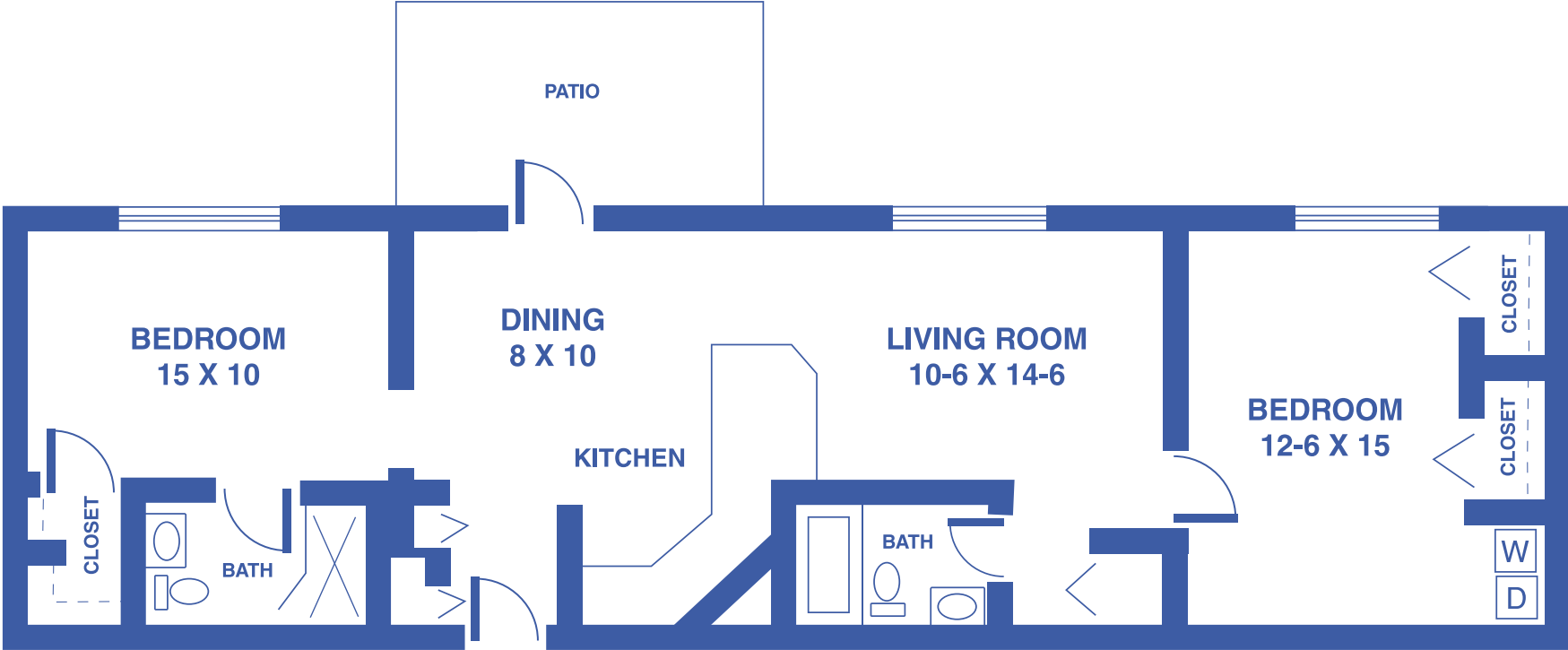

Floor plans may vary slightly and are not to scale.



4712 SW 6TH AVE, TOPEKA, KS • WWW.TOPEKAPRESBYTERIANMANOR.ORG



TOPEKA

Presbyterian Manor®